

# EQUATOR FRAME PANEL INSTRUCTION SHEET

## Diagram

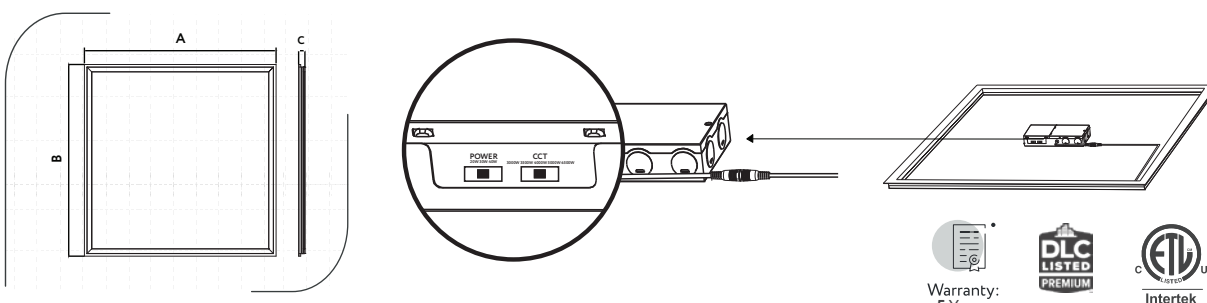

Warranty:  
5 Years



## FEATURES

INPUT VOLTAGE	AC 100 - 277V
OPERATING FREQUENCY	50-60 HZ
POWER FACTOR	>0.95
AMBIENT TEMPERATURE RANGE	-20°C ~ + 45°C
COLOR TEMP	3000-6500K
DIMMABLE	0-10V Dimming
THD	≤10%
IP RAITING	IP40
CRI	>Ra80
BEAM ANGLE	120°

ITEM			
SIZE	2X2	1X4	2X4
MODEL	G-12122, G-12123	G-12120, G-12121	G-12124, G-12125
CERTIFICATION	ETL/cETLus,DLC	ETL/cETLus	ETL/cETLus,DLC
CRI	>80	>80	>80
WATTAGE	20/30/40W	20/30/40W	40/50/60W
CCT COLORS	3000/3500/4000/5000/6500K	3000/3500/4000/5000/6500K	3000/3500/4000/5000/6500K
FUNCTION	0-10V dimming CCT tunable & power adjustable	0-10V dimming CCT tunable & power adjustable	0-10V dimming CCT tunable & power adjustable
LUMENS	5200/3900/2600	5200/3900/2600	7800/6500/5200

## Diagram

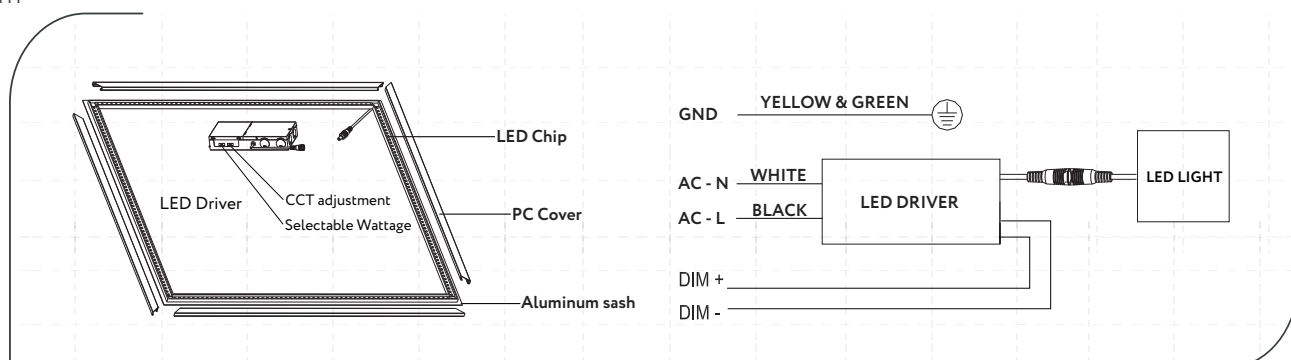

## Installation instruction

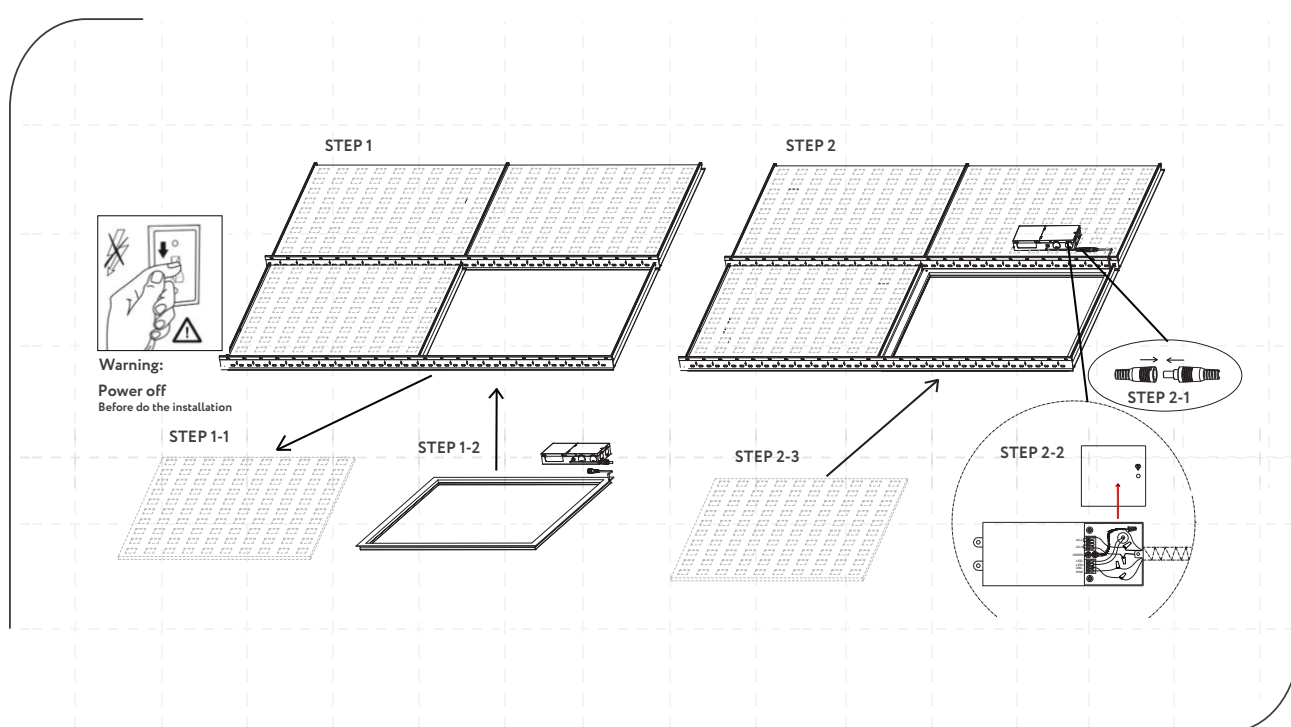

Step 1: Make sure that the power is off before installing. Remove the one ceiling tile that you want to install the light fixture on. Then place the light fixture on the T-bar carefully and make sure it is correctly in place and secure.

Step 2: Lift the 4 buckles on the back of the panel up by 90° then bend the top part of the buckles 90° towards the direction where you can anchor the light fixture to the T-bar.

Step 3: Place the driver on top of the lighting fixture in the back. Connect the cable between the driver and the lighting fixture. Open the driver's junction box and connect the AC wire to the driver correctly (L=black & N=white)

### Notice:

1. Please make sure the power is off before installation (this installation can only be done by certified electricians).
2. Adjust the wattage and kelvin color on the driver to your desired setting.
3. Product voltage is 100-277 volts. Please make sure that the voltage range meets the requirements.
4. please don't use chemicals to clean the lighting surface.