

Saturn 3.5" Gimbal Trimless Instruction Sheet

- ❗ IMPORTANT** Read all instructions before installing plate. Retain for future reference.
- ⚠ SAFETY:** Turn the power at off main fuse/breaker panel before attempting any electrical work. This luminaire must be wired in accordance with local electrical codes and ordinances. Grounding connections should be done in the detachable junction box.
- ⚠ WARNING:** Make sure the power is OFF from the electrical panel before starting or installation attempting any maintenance.

INSTALLATION INSTRUCTIONS:

1. Measure distance from walls and mark position of fixture to be installed on ceiling.
2. Carefully scribe hole template, in accordance to cut hole size on desired location.
3. Carefully cut hole in ceiling (Fig. 1).
4. Follow steps 1 through 4 under "electrical connections".
5. Connect driver enclosure to engine by connector.
6. Pass the driver enclosure and attached bx cable through the hole and place on straight surface inside the ceiling cavity.

ELECTRICAL CONNECTIONS:

1. Provide electrical service according to your local electrical code for a suitable junction box. Supply wire insulation must be rated for at least 90°C.

2. Remove the driver enclosure cover. Remove the appropriate knock-out(s) to accommodate the type of electrical service to be used.

3. Insert electrical supply cable through knock-out in the driver enclosure and secure with cable connector. Wire enclosure using pre-installed push-in connectors.

Do the wiring as per National Electric Code standards. (Fig. 4)

- A. Connect green ground wire of cable to green wire on fixture.
- B. Connect white wire of cable to white wire of fixture.
- C. Connect black wire of cable to black wire of fixture
4. If using 0-10V dimming, connect matching purple and pink wires with the supplied wire nuts.
5. Place all wiring and connections back in driver enclosure and replace the cover.

1. Follow steps 1 through 5 under "electrical connections".
2. Align the mesh adapter with the drywall hole and screw in place (Fig. 2). Ensure to pull driver lead through the trimless adapter for engine install.
3. Plaster over the trimless mesh adapter, be careful not to fill past raised trim. (Fig. 3).
4. Connect driver enclosure to engine with connector and twist the cap of the DC connector well.
5. Insert cable and engine into trimless mesh adapter opening (Fig. 5).
6. Push the Fixture into the mesh with right direction. Twisting the fixture clockwise. Please make sure the fixture is well-installed, After all installation steps are finished, turn on the power to check if the lights work properly. (Fig. 6).

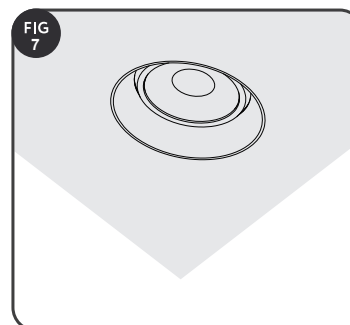
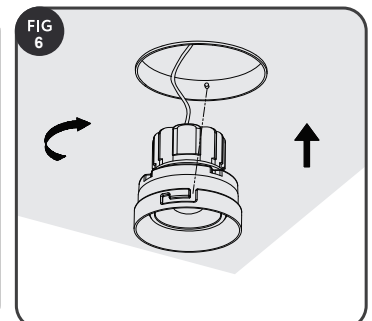
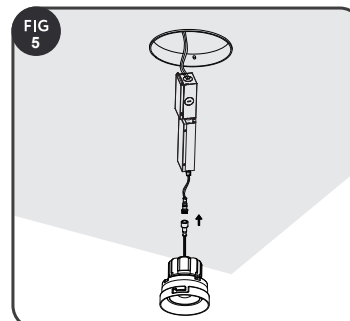
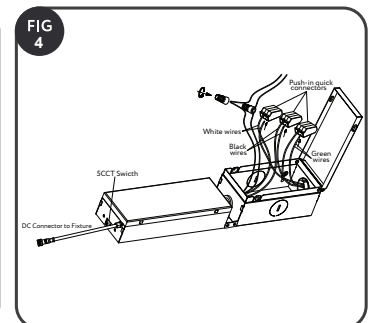
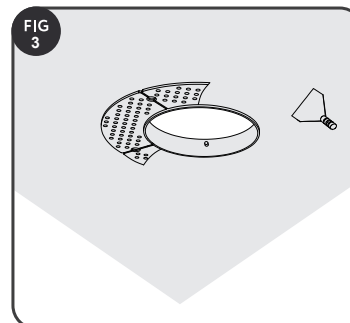
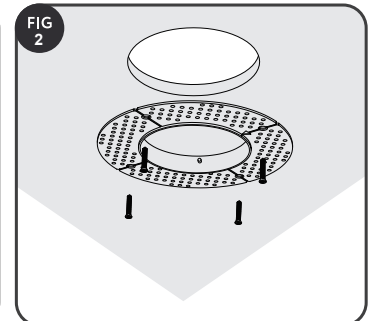
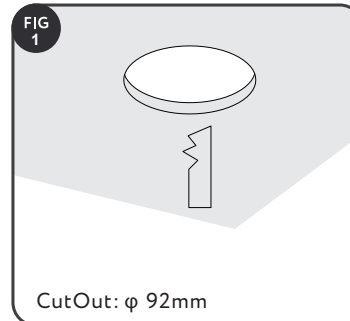

Hole Cut Size

G-95626 & G-95726 ϕ 3.74" (95mm)

	Model	G-95626 & G-95726
DRIVER	Input	120-277 V AC 50/60Hz
	Output Voltage	33-38V DC
	Output Current	340mA CC
	Lamp Life	50000 Hours
	Operating Temperature	-20°C to +40°C
	Dimming	Triac dimming (120V AC input only) 0-10V dimming (120-277V AC input)
	DC Wire Type	FT6 DC Wire
	Wire Space	10 Cubic inch
	LIGHT	Energy used
Luminous Flux		1400 LM
Equivalent to:		140W Halogen
CCT Options		2700K-3000K-3500K-4000K-5000K
Beam Angle		60°/head
CRI		RA>90
Approved Location		Wet Location
MOUNTING		OD
	ID	ϕ 3.3"(84mm)
	Height	3.54"(90mm)
	Cut-Out	ϕ 3.74"(95mm)

Dimmer Compatibility List for LED Recessed Lights. Dimmable down to 10%					
Brand	Family	Model	Load (W)	G-95626 & G-95726	
LUTRON	Skylark Contour	LECL-153P	150W	10	
		CTCL-150H	150W	10	
		LGCL-153PLH	150W	10	
		CTCL-153P	150W	10	
		SCL-153P	150W	10	
		S-600P	600W	14	
	Caseta	PD-6WCL	600W	14	
		PD-5NE	150W	10	
		PD-10NXD	250W	14	
		DIVA	DVCL-153P	150W	10
		Toggler	TGCL-153P	150W	10
		Ariadni	AYCL-153P	150W	10
Maestro	MACL-153M	150W	10		
LEVITON	Illumatech	IPL06	150W	10	
	SureSlide	6672	150W	10	
EATON	Smart Dimmer	AAL06	300W	14	